

Regupol® SonusClip™ Sound Isolation Clip



REGUPOL® SONUSCLIP™



Regupol® SonusClip™ is designed to reduce sound transmissions from both airborne and impact noise in wood, steel or concrete construction for both interior walls and ceilings. The SonusClip system is used to attach gypsum wall board (GWB) for walls and ceilings that allows the GWB to float and absorb energy due to the resilient rubber isolators, causing an increase in the acoustic performance for both STC (airborne) and IIC (impact) ratings. Each SonusClip has a design load rating of 36 lbs. per isolator, the SonusClip can support up to two layers of 5/8" gypsum board when spaced no more than 24" x 48" on-center.

SonusClip Specifications	
Design Load	36 lbs. per clip
Recycled Content	Yes
VOC Treated	Yes
Total Deflection	3mm
Adjustable	No
Use on Walls	Yes
Use on Ceilings	Yes
UL Fire Tested	Yes

Please contact us or visit regupol-acoustics.com for more information.

Interior Wall Assemblies



Framing: 2 x 4 Wood Stud, 16" o.c.
Insulation: 3-1/2" Fiberglass
Isolation: None – direct applied
Side 1: 5/8" Gypsum Wall Board
Side 2: 5/8" Gypsum Wall Board



Framing: 2 x 4 Wood Stud, 16" o.c.
Insulation: 3-1/2" Fiberglass
Isolation: SonusClips with Hat Channel
Side 1: 5/8" Gypsum Wall Board
Side 2: 5/8" Gypsum Wall Board



Framing: 2 x 4 Wood Stud, 16" o.c.
Insulation: 3-1/2" Fiberglass
Isolation: SonusClips with Hat Channel
Side 1: Two 5/8" Gypsum Wall Boards
Side 2: 5/8" Gypsum Wall Board



Framing: 3-5/8" Steel Studs, 20 Gauge, 16" o.c.
Insulation: 3-1/2" Fiberglass
Isolation: None – direct applied
Side 1: 5/8" Gypsum Wall Board
Side 2: 5/8" Gypsum Wall Board

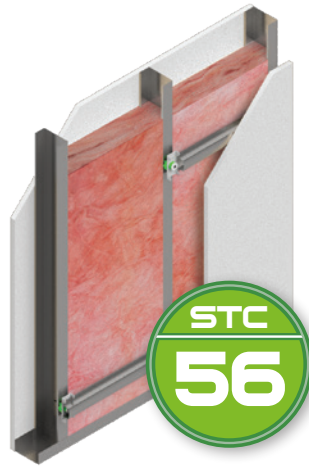

Framing: 3-5/8" Steel Studs, 20 Gauge, 16" o.c.
Insulation: 3-1/2" Fiberglass
Isolation: SonusClips with Hat Channel
Side 1: 5/8" Gypsum Wall Board
Side 2: 5/8" Gypsum Wall Board



Framing: 3-5/8" Steel Studs, 20 Gauge, 16" o.c.
Insulation: 3-1/2" Fiberglass
Isolation: SonusClips with Hat Channel
Side 1: Two 5/8" Gypsum Wall Boards
Side 2: 5/8" Gypsum Wall Board

Regupol America, LLC is a product manufacturer and does not represent itself as a consultant, engineer, or advisor in construction methods, standards, and compliance. Therefore, Regupol America only warrants its products under its standard limited warranty (available by request), and does not represent or warrant any advice, suggestions, instructions, whether formal or informal, oral or written, in conjunction with any sales of its products. Any such advice is not intended for a particular purpose and should not be acted or relied upon as such. Any such advice is not represented as being all-inclusive, correct, complete or up-to-date. The information and data contained herein are based on industry accepted testing, manufacturing tolerances and prior product usage as set forth. It is intended as descriptive of the performance characteristics and capabilities of Regupol/Regufoam and does not certify applicability for any particular or specific project. Technical assistance, calculations and design recommendations are available from Regupol America, and are subject to terms and conditions provided upon request.

Floor-Ceiling Assemblies

2 x 10 Wood Construction

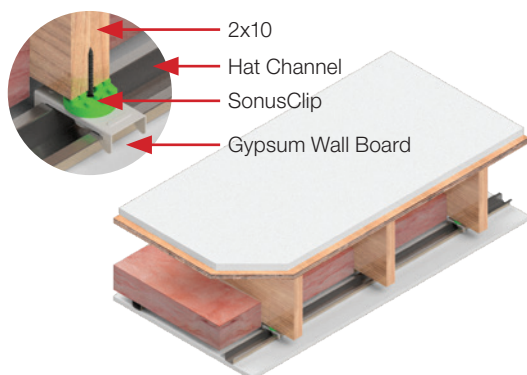

Floor: 1" Gypsum Topping
3/4" Plywood
Framing: 2 x 10, 16" o.c.
Insulation: 3 1/2" Fiberglass
Isolation: SonusClips with Hat Channel
Ceiling: 5/8" Gypsum Wall Board

Floor Covering	Underlayment	STC	IIC
Bare - just clips	None	60	51
Hardwood	None	60	56
Hardwood	Sonus 3mm & 5mm	59	58
Hardwood	Sonus 10mm	60	60
Tile	Sonus 5mm	61	55
Vinyl	None	61	55
Vinyl	Sonus LV270	59	57

18" Open Web Construction

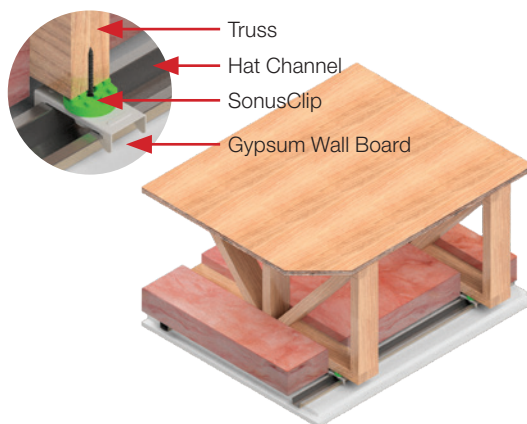

Sub-floor: 3/4" Plywood
Framing: 18" Open Web Truss, 24" o.c.
Insulation: 3 1/2" Fiberglass
Isolation: SonusClips with Hat Channel
Ceiling: Two 5/8" Gypsum Wall Boards

Floor Covering	Underlayment	STC	IIC
Hardwood	None	60	53
Hardwood	Sonus 3mm	60	55
Hardwood	Sonus 5mm	60	55
Hardwood	Sonus 10mm	60	58
Tile	Sonus 5mm	60	58
LVT	Sonus LV270	60	53

Regupol® SonusClip™ Sound Isolation Clip

Product Accessories

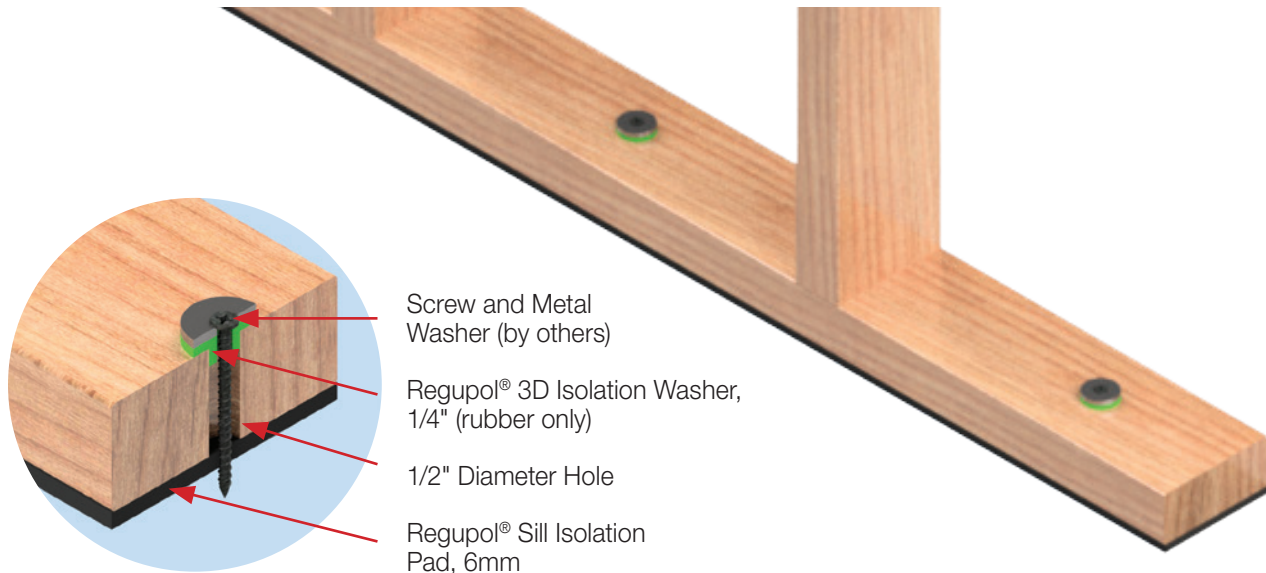

3D Isolation Washer



Sill Isolation Pad

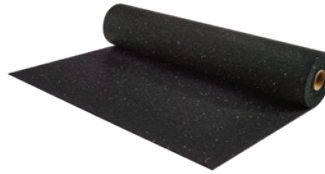

Sonus Underlayment



SonusClip DE90

information at: regupol-acoustics.com



REGUPOL® ACOUSTICS

Download or request
additional information about
the Regupol® family of Sound Control,
or Vibration Isolation products at
Regupol-Acoustics.com

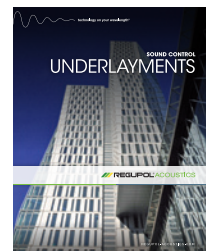

The information and data contained herein are based on industry accepted testing, manufacturing tolerances and prior product usage as set forth. It is intended as descriptive of the performance characteristics and capabilities of Regupol/Regufoam and does not certify applicability for any particular or specific project. Technical assistance, calculations and design recommendations are available from Regupol® America, and are subject to terms and conditions provided upon request.